

safety-compact-drive with electronic components diverter pulley

scale 1:2

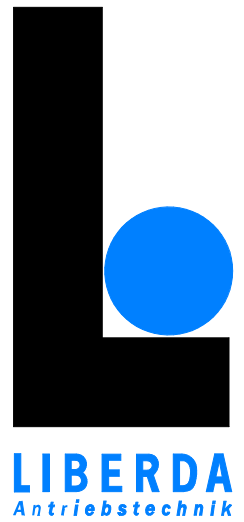
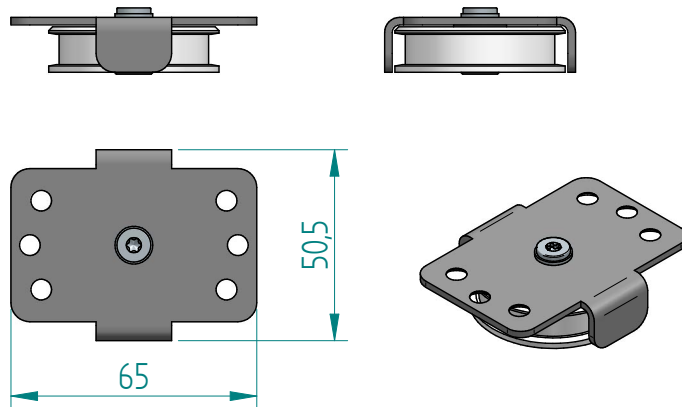

motor and toothbelt carrier with bistable magnetic lock

scale 1:4,5

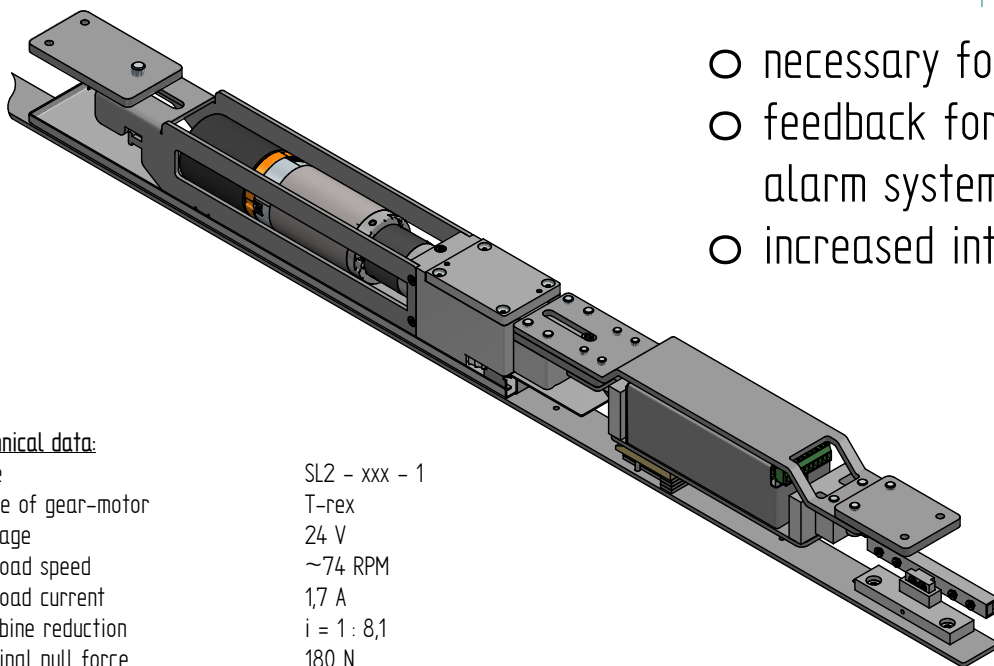
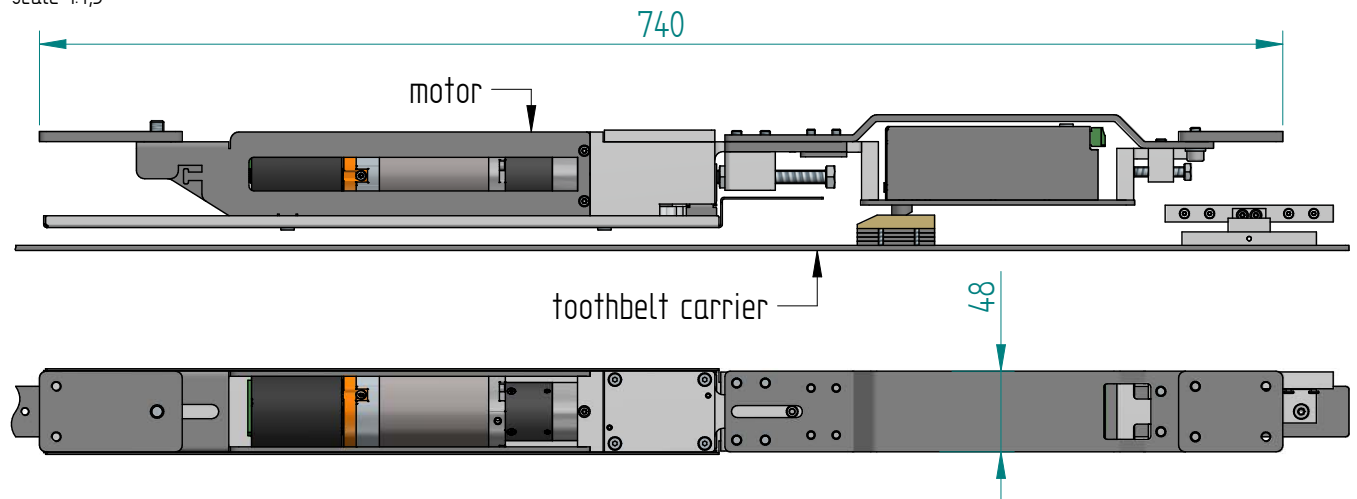

- necessary for external doors
- feedback for external alarm system integrated
- increased intruder protection

technical data:

type	SL2 - xxx - 1
name of gear-motor	T-rex
voltage	24 V
no load speed	~74 RPM
on load current	1,7 A
combine reduction	i = 1 : 8,1
nominal pull force	180 N
pinion	T5 / 27
drive means	toothbelt 6AT5
breaking strength:	1525 N

The control has a sensitivity control. The door is movable by hand with > 75N.
Operation in hold-to-run mode.

created on 27.02.2025 | subject to changes

Liberda Antriebsstechnik GmbH
A-1150 Wien
Geibelgasse 14-16
☎ +43 1 8953244
☎ +43 1 8953244 20
✉ antriebe@liberda.eu
www.liberda.eu
HG Wien FN113227k