

# safe-compact-drive with electronic components type: SKA-AG5-Li-1

## motor

scale 15

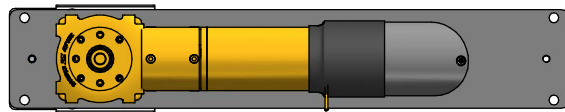
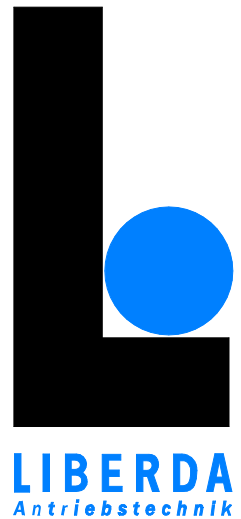
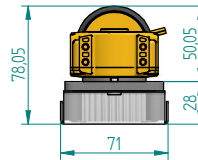
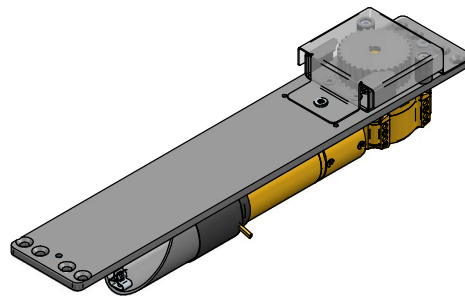
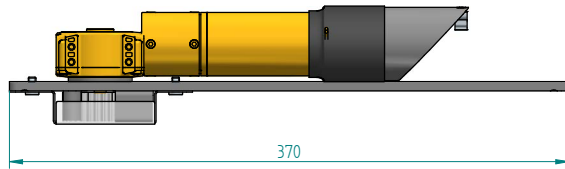

## operating element & power supply

scale 15

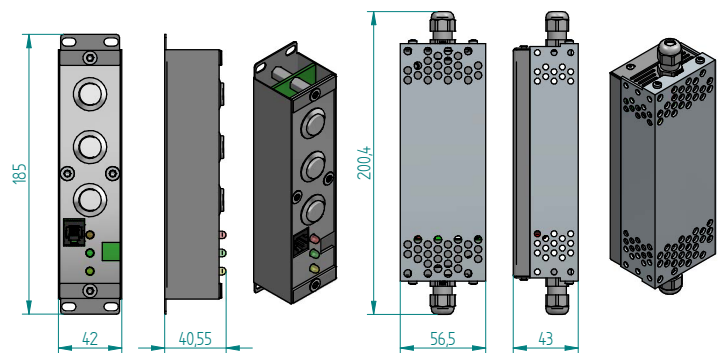

## diverter pulley

scale 15

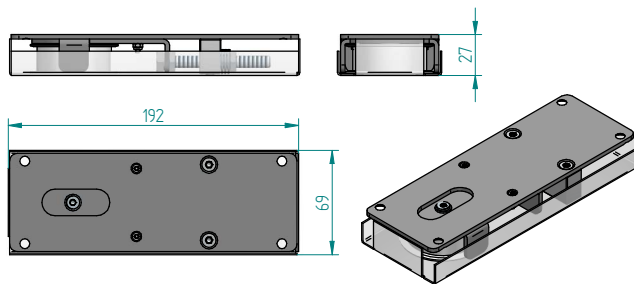

## control unit

scale 110

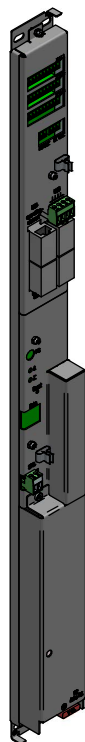
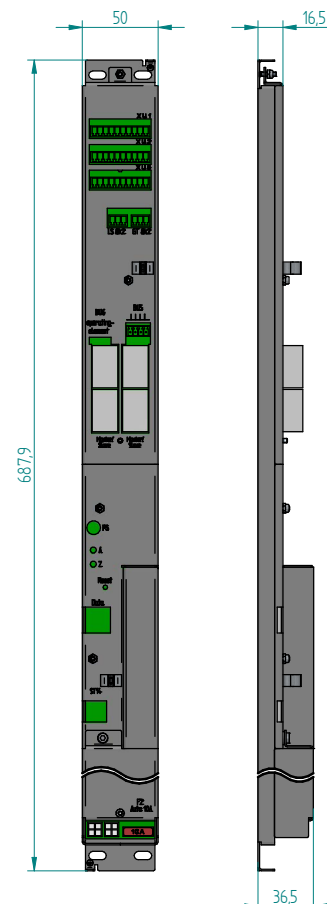

## toothbelt carrier

scale 15

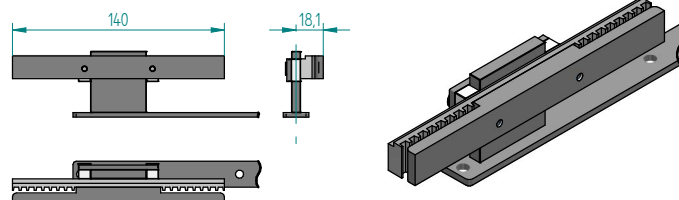

### technical data:

type	SKA-AG5-Li-1
name of gearbox	EtaCrown 52
motor designation	BCI4240
voltage	24V
output speed	3100/min
torque	5,55Ncm
gearbox producer	Zeitlauf
reduction	i = 1:60
max. nominale torque	2,7Nm
nominal pull force	108N
pinion	T5/32
drive means	toothbelt RPP5/15, maximum load: 700N, safety factor for breaking stress > 4

The control has a sensitivity control. The door is movable by hand with > 400N.  
Operation in hold-to-run mode or automatic mode, low energy drive according to EN 16005.

Liberda Antriebstechnik GmbH  
A-1150 Wien  
Geibelgasse 14-16  
☎ +43 1 8953244  
☎ +43 1 8953244 20  
✉ antriebe@liberda.eu  
www.liberda.eu  
HG Wien FN13227K