

safety-compact-drive with electronic components type: SKA-AG5-1

motor

scale 1:5

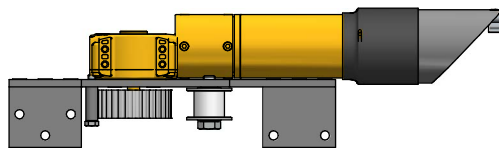
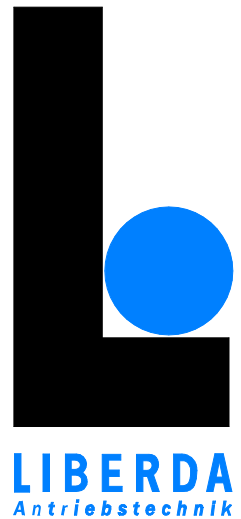
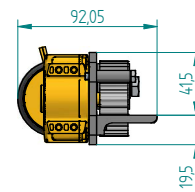
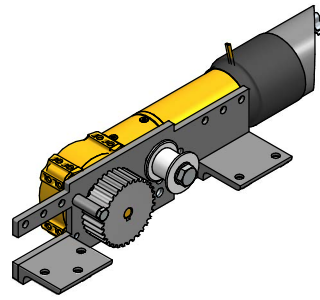
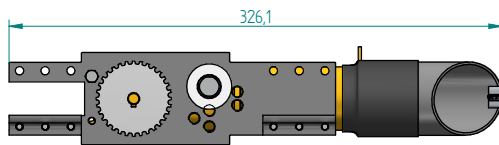

operating element & power supply

scale 1:5

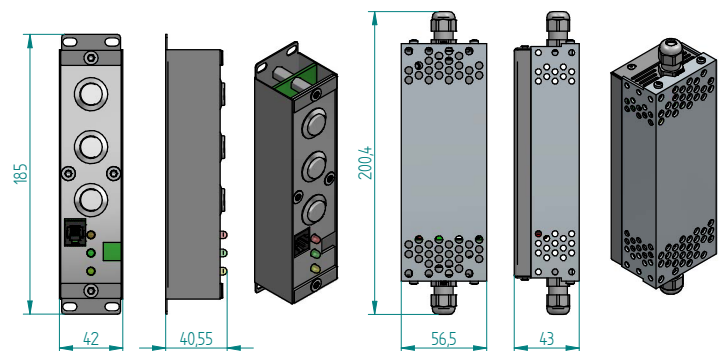

diverter pulley

scale 1:5

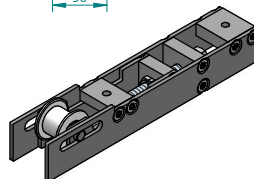
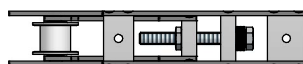
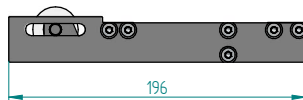

control unit

scale 1:10

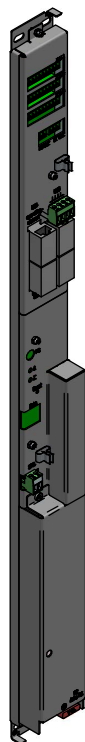
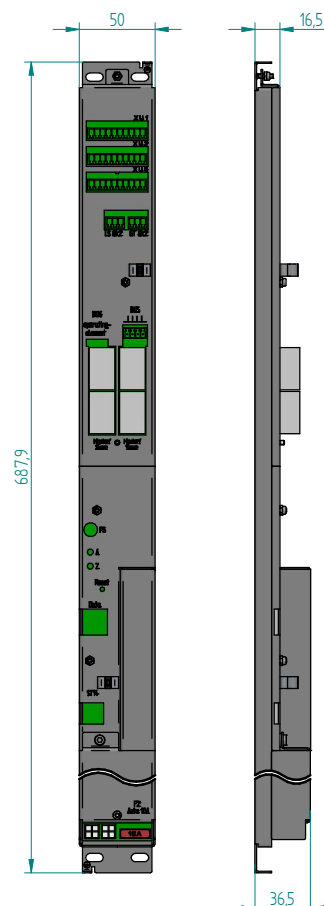

toothbelt carrier

scale 1:5

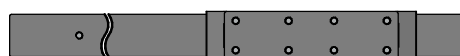

technical data:

type	SKA-AG5-1
name of gearbox	EtaCrown 52
motor designation	BCI4240
voltage	24V
output speed	3100/min
torque	5,5Ncm
gearbox producer	Zeitlauf
reduction	i = 1:60
max. nominater torque	2,7Nm
nominal pulling force	108N
pinion	T5/32
drive means	toothbelt ML RPP5/15, maximum load: 700N, safety factor for breaking stress > 4

The control has a sensitivity control. The door is movable by hand with > 400N
Operation in hold-to-run mode or automatic mode, low energy drive according to EN 16005.

Liberda Antriebstechnik GmbH
A-1150 Wien
Geibelgasse 14-16
☎ +43 1 8953244
☎ +43 1 8953244 20
✉ antriebe@liberda.eu
www.liberda.eu
HG Wien FN13227k